

# RANPLAN TABLET

Automate site survey and in-building network designs

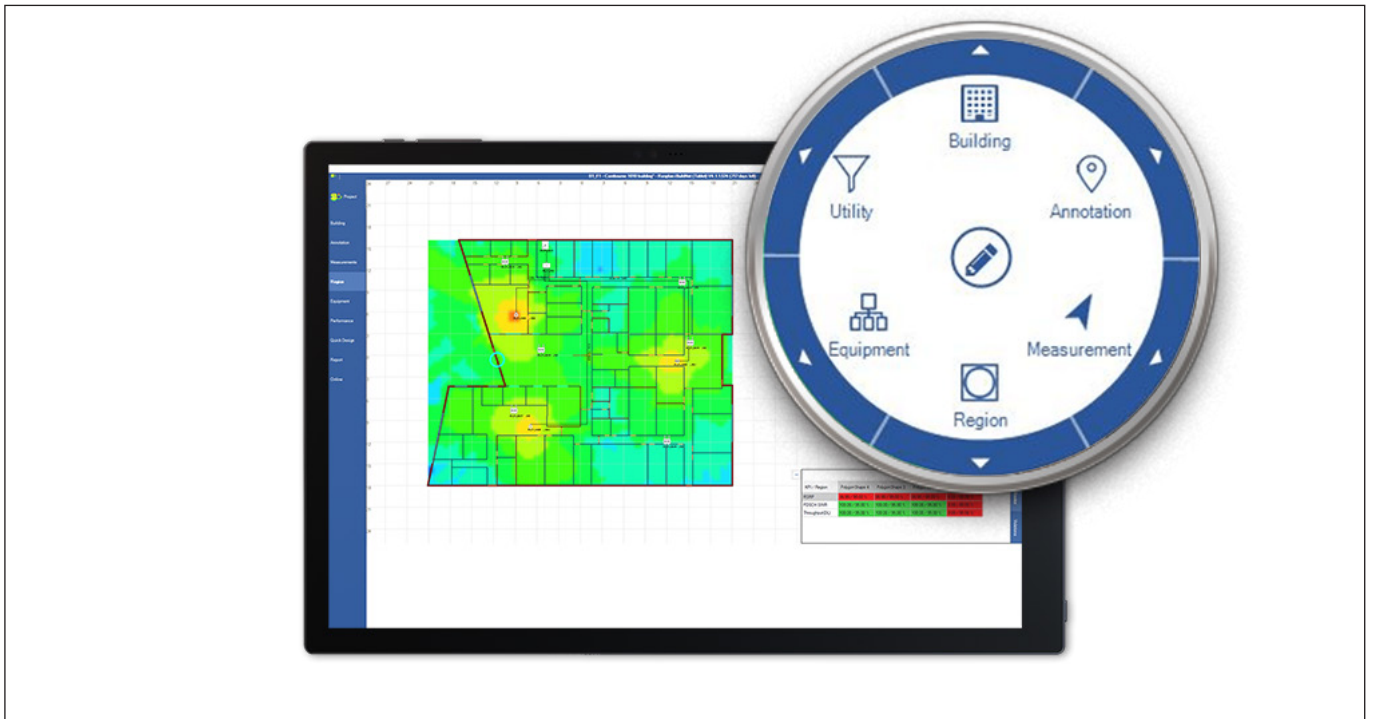

**Ranplan Tablet** makes it easy for onsite RF engineers to produce site surveys, run rapid network performance predictions and generate quotations and bills of materials when planning WiFi, 3G, 4G (LTE), 5G, IoT and Public Safety networks.

The ability to quickly generate quotes, run accurate indoor network KPI predictions and produce eye-catching visualisations will help will help integrators win bids from operators.

## Product Capabilities

- Automates site survey and design process
- Used for planning indoor capacity and coverage
- Supports 2.5D modelling & 3D ray-tracing
- Seamlessly interoperates with Ranplan Professional and Collaboration Hub.

Learn more:

[www.ranplanwireless.com/products](http://www.ranplanwireless.com/products)

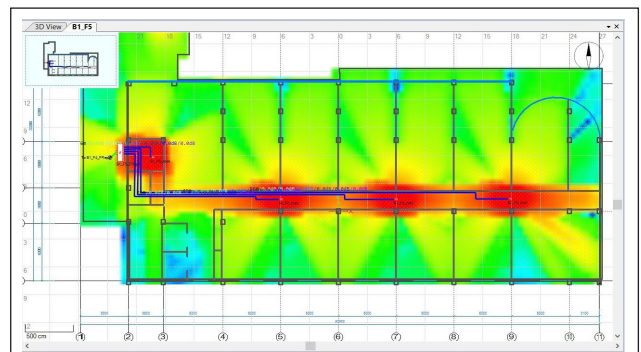

*Indoor coverage heatmap*

## Simplify and speed up onsite network design

Ranplan Tablet is an ideal onsite survey tool for RF engineers or technicians to go onsite and easily and quickly capture building information to start the process of planning a network. The enhanced and intuitive GUI and Intelligent Design Module helps even users with limited RF planning or optimisation knowledge with a tool to rapidly plan preliminary indoor networks. Information collected can then be shared with other team members through seamless interoperability with Ranplan Professional and Collaboration.

- **Tablet based site survey RF planning and installation tool**
- **Easily import data from multi-vendor test and measurement tools**
- **Create annotations in text, image, audio and video formats**
- **Live multi-vendor component database.**



*Engineer validating indoor network design onsite*

## Evaluate planned indoor coverage onsite

Once the building data has been collected and the building model created, Ranplan Tablet helps users easily plan their networks to meet required KPIs. By creating target and candidate regions users can define a set of coverage KPIs and even order zones of interest by priority, distinguishable by colour. With capacity and coverage heatmaps users can visualise predicted network performance based on defined KPIs.

- **Generate statistics and analytics based on measurement campaign data**
- **Rapidly generate onsite coverage and capacity RF planning and optimisation for HetNet environments**
- **use Intelligent Design Module to increase network design automation**
- **Supports designs for active and passive DAS, small cells and WiFi.**

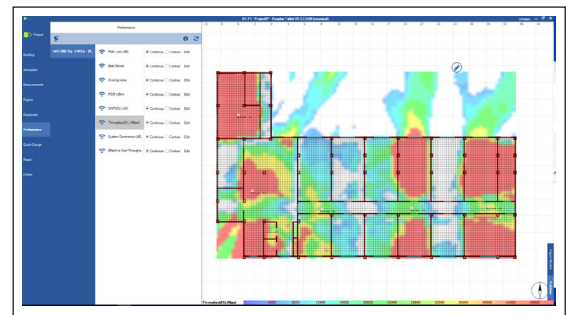

*Throughput heatmap*

## Produce customisable project reports

A number of different reports can be generated to easily verify and validate a proposed system design and be integrated as part of the project bidding process to help quickly produce quotes and sales estimates. The reports also help operators rapidly estimate the real cost of building a network capable of delivering the required quality of experience to their end customers.

- **Floor plans, system design schematics and SPE heatmaps**
- **Quickly produce quotations, bills of materials and other customisable reports**
- **Access predefined data templates for costs and compliance requirements**
- **Fully interoperable with Professional Professional and Ranplan Collaboration Hub.**

Layout Plan Report						
Project name: Lambaafeld			Design company: Design Company			
Project creation date: 2/1/2017			Designer: Designer			
Type	DeviceID	Manufacturer	Model	Floor	Lat/Lon	Description
1044511-0111-400-17-01	JN170	CommScope	Fiber	None	N/A	CommScope Active Intelligent Point of Interface, 400, 1700 Band, 400T5
1044511-0111-400-17-02	JN170	CommScope	Fiber	None	N/A	CommScope Active Intelligent Point of Interface, 400, 1700 Band, 400T5
1044511-0111-400-17-03	JN170	CommScope	Fiber	None	N/A	CommScope Active Intelligent Point of Interface, 400, 1700 Band, 400T5
1044511-0111-400-17-04	JN170	CommScope	Fiber	None	N/A	CommScope Active Intelligent Point of Interface, 400, 1700 Band, 400T5
1044511-0111-400-17-05	JN170	CommScope	Fiber	None	N/A	CommScope Active Intelligent Point of Interface, 400, 1700 Band, 400T5
1044511-0111-400-17-06	JN170	CommScope	Fiber	None	N/A	CommScope Active Intelligent Point of Interface, 400, 1700 Band, 400T5
1044511-0111-400-17-07	JN170	CommScope	Fiber	None	N/A	CommScope Active Intelligent Point of Interface, 400, 1700 Band, 400T5
1044511-0111-400-17-08	JN170	CommScope	Fiber	None	N/A	CommScope Active Intelligent Point of Interface, 400, 1700 Band, 400T5
1044511-0111-400-17-09	JN170	CommScope	Fiber	None	N/A	CommScope Active Intelligent Point of Interface, 400, 1700 Band, 400T5
1044511-0111-400-17-10	JN170	CommScope	Fiber	None	N/A	CommScope Active Intelligent Point of Interface, 400, 1700 Band, 400T5

*Customisable reports*

## Hardware Requirements

### Recommended Requirement:

- **Processor:** 2.0 GHz (Intel Atom)
- **Operating System:** Windows 10 or later versions
- **Memory:** 4GB+
- **Hard Disk Space:** 300GB
- **Display:** 10", 1024x768, 32 bit
- **Camera:** Rear facing